

# ARPA PRESENTATIONS

April 13<sup>th</sup>

Wednesday Morning

9:00-9:15	Call to Order / Pledges / Welcome
9:15-9:35	<b>Presentation #1 – Handouts - We Are ReInspire – Charise Olson, Executive Director</b>
9:35-9:45	Q & A
9:45-10:05	<b>Presentation #2 – Slide - Promises Community Ministry – Debbie Beeman, Director</b>
10:05-10:15	Q & A
10:15-10:35	<b>Presentation #3 – Chisholm Trail Outdoor Museum – David Murdoch, CEO/Chairman &amp; Carrie Reynolds, On-Site Director</b>
10:35-10:45	Q & A
10:45-11:05	<b>Presentation #4 – Slide/Handouts – Center of ASD – Valerie Sims, Grant Coordinator &amp; Lisa Boultinghouse, CEO/Founder</b>
11:05-11:15	Q & A
11:15-11:35	<b>Presentation #5 – Slide – Johnson County Sheriff’s Posse – Phil Williams, Treasurer</b>
11:35-11:45	Q & A
11:45-12:00	Wrap up for lunch / Recess till 1:30

Wednesday Afternoon

12:00-1:30	Lunch
1:30-1:45	Welcome Back
1:45-2:05	<b>Presentation #6 – Slide – Pathway – Ray Bussell, General Manager</b>
2:05-2:15	Q & A
2:15-2:35	<b>Presentation #7 – Slide/Handouts – Texas Health Cleburne – Ajith Pai, President &amp; Marsha Ingle, Senior Director, Community Health Improvement</b>
2:35-2:45	Q & A
2:45-3:05	<b>Presentation #8 – Slide – City of Rio Vista – Kent Riker, Engineer with Provenance Engineering, Chad Wilson, Owner of ITC Services &amp; Jeff Faraizl, Mayor of Rio Vista</b>
3:05-3:15	Q & A
3:15-3:35	<b>Presentation #9 – Slide – United Cooperative Services – Landy Bennett, CAO</b>
3:35-3:45	Q & A
3:45-4:05	<b>Presentation #10 – Handout – Crazy8 Ministries – Lisa Schwarz, Founder, CEO</b>
4:05-4:15	Q & A
4:15-4:20	Wrap Up

APR 13 2022

American Rescue Plan Project Submission Form

**Project Name** - A short name for your project, such as "Sewer Line Expansion along Main St."

**Tabled**

Pathway Fiber to the Premise for underserved Johnson County consumers.

**Primary Point of Contact** - The name and contact information for the person in your organization that should be contacted first about this project for more details.

Ray Bussell  
General Manager  
817-484-2650  
ray@aciglobal.com

**Project Description** - A description of your project or item for purchase in 250 words or less, including why the project is needed and how that need will be met.

To provide Fiber to the premise for both residential and businesses in areas of Johnson County. Due to the rapid growth of Johnson County, there are several residents/businesses that have been passed over for modern broadband facilities, leaving these consumers with Internet service that fails to meet the definition of modern broadband service.

With ARPA funding Pathway will build fiber to the Premise in these underserved areas. Tying them to Pathway's existing, robust Fiber Network. This will allow these customers to receive Gig to HyperGlg internet speeds.

**Project Location** - Where your project will be performed, such as "500 feet along Main Street". Include maps, if available.

City of Godley and Joshua developments: Old Mountain Valley, Mountain Valley Blvd., Cooper Valley, Lonestar street area east of Hwy 174, Henderson, Apple, Plum streets and Pear CT., Cotton wood Street, Stadium Dr, Old Town Joshua west of Hwy 174.

**Project Budget** - A rough estimate of the budget required for your project.

\$1,800,000 is a rough estimate for the above project.

**Project Timeframe** - An estimate of how long it will take to start the project, how long the project will take to complete, and how long it will take to expend all funds related to the project.

From date of award Pathway could begin construction on the project within 30 days, barring unforeseen circumstances and delays in materials.

We anticipate completion of the project within a year of awarded funds, with all funds being expended within 15 months after award date.

Rachel Sitrler

---

**From:** ray@aciglobal.com  
**Sent:** Tuesday, March 8, 2022 5:18 PM  
**To:** kevin.dyer@grantworks.net; County Judge (public address)  
**Subject:** APRA Funds  
**Attachments:** 637787993993330000.pdf

Some people who received this message don't often get email from ray@aciglobal.com. [Learn why this is important](#)

**\* External sender - use caution with links or attachments \***

Good evening,

Here is our application to request ARPA funds from Johnson County.

Thank you for your consideration.



**Pathway**

*Ray Bussell*

*General Manager*

*Pathway Com-Tel, Inc.*

*P: 817-484-2222*

*M: 817-228-2937*

*A: P.O. Box 1298 Joshua TX 76058*

*www.usapathway.com*

*Follow us:*





ESTABLISHED IN 1997

[www.usapathway.com](http://www.usapathway.com)

Ray Bussell

# ABOUT US

- WE ARE A LOCALY OWNED FAMILY BUSINESS
- 27 EMPLOYEES
- ONE OF THE FIRST, IF NOT THE FIRST FIBER TO HOME COMPANIES IN TEXAS
- COMMUNITY INVOLVEMENT
- EXPANDING OUR SERVICES



# SERVICES WE OFFER?

- FIBER OPTICS TO THE CUSTOMER'S PREMISE
- FIBER BROADBAND AND PHONE SERVICES WITH CALIX EQUIPMENT
- SPEEDS
- COMPETITIVE PRICING
- EXCELLENT CUSTOMER SERVICE
- 24-HOUR TECH SUPPORT/BASED IN THE U.S

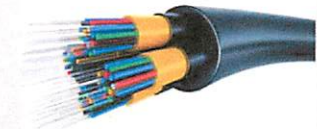

This Photo  
by Unknown  
Author is  
licensed  
under [CC BY-  
SA-NC](#)



# FIBER PROJECTS

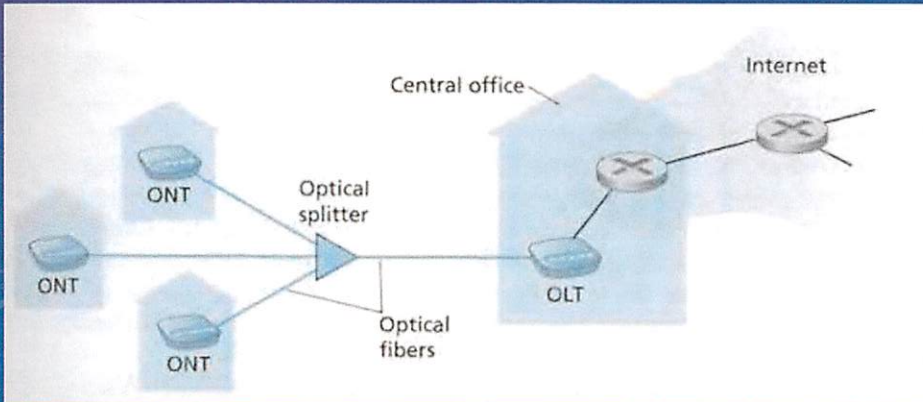

Author is licensed under C



[This Photo](#) by Unknown Author is licensed under [CC BY-SA](#)

# FUTURE PROJECTS

LOCATION	FIBER MATERIAL COST	LABOR COST	TOTAL COST	HOMES PAST +/-
Old Mountain Valley	\$110,100.00	\$335,800.00	\$445,900.00	245
Mountain Valley Blvd	\$14,335.00	\$37,500.00	\$51,835.00	55
Behind Fast Taco	\$61,050.00	\$75,450.00	\$136,500.00	360
Cooper Valley	\$69,290.00	\$51,800.00	\$121,090.00	160
Fruit Streets	\$25,290.00	\$21,730.00	\$47,020.00	80
Old Town Joshua	\$58,106.00	\$60,275.00	\$118,381.00	300
Trailwood Dr & Little Brook Estates	\$53,590.00	\$36,270.00	\$89,860.00	80
City of Godley	\$135,000.00	\$453,126.00	\$588,126.00	392
<b>Total Cost Fiber and Labor</b>			<b>\$1,598,712.00</b>	
<b>Electronics and Cabinets</b>			<b>\$350,000.00</b>	
<b>Total Project</b>			<b>\$1,948,712.00</b>	
<b>Total Homes Past</b>				<b>1672</b>
<b>Average Cost Per Home</b>				<b>\$1,165.50</b>





GODLEY

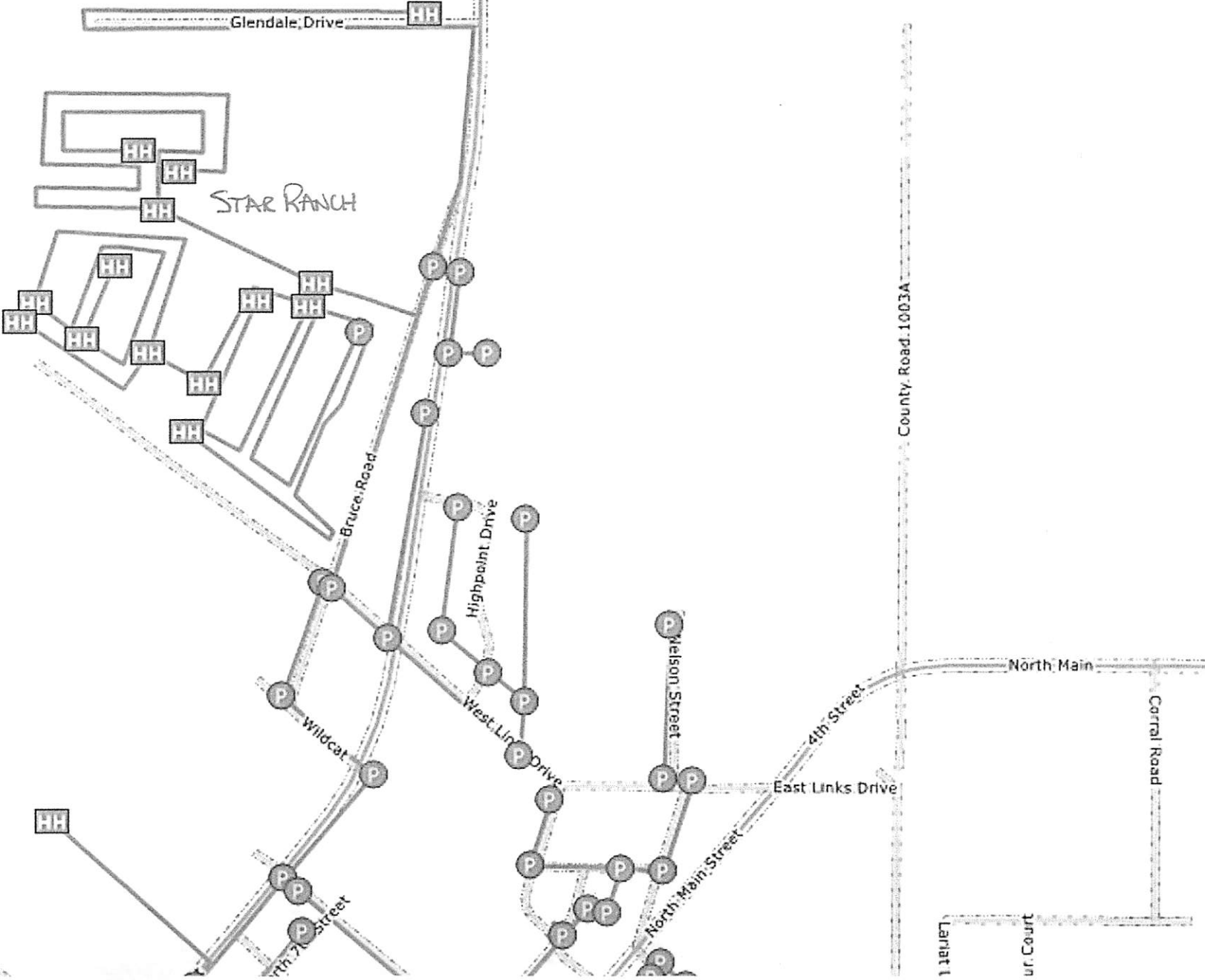

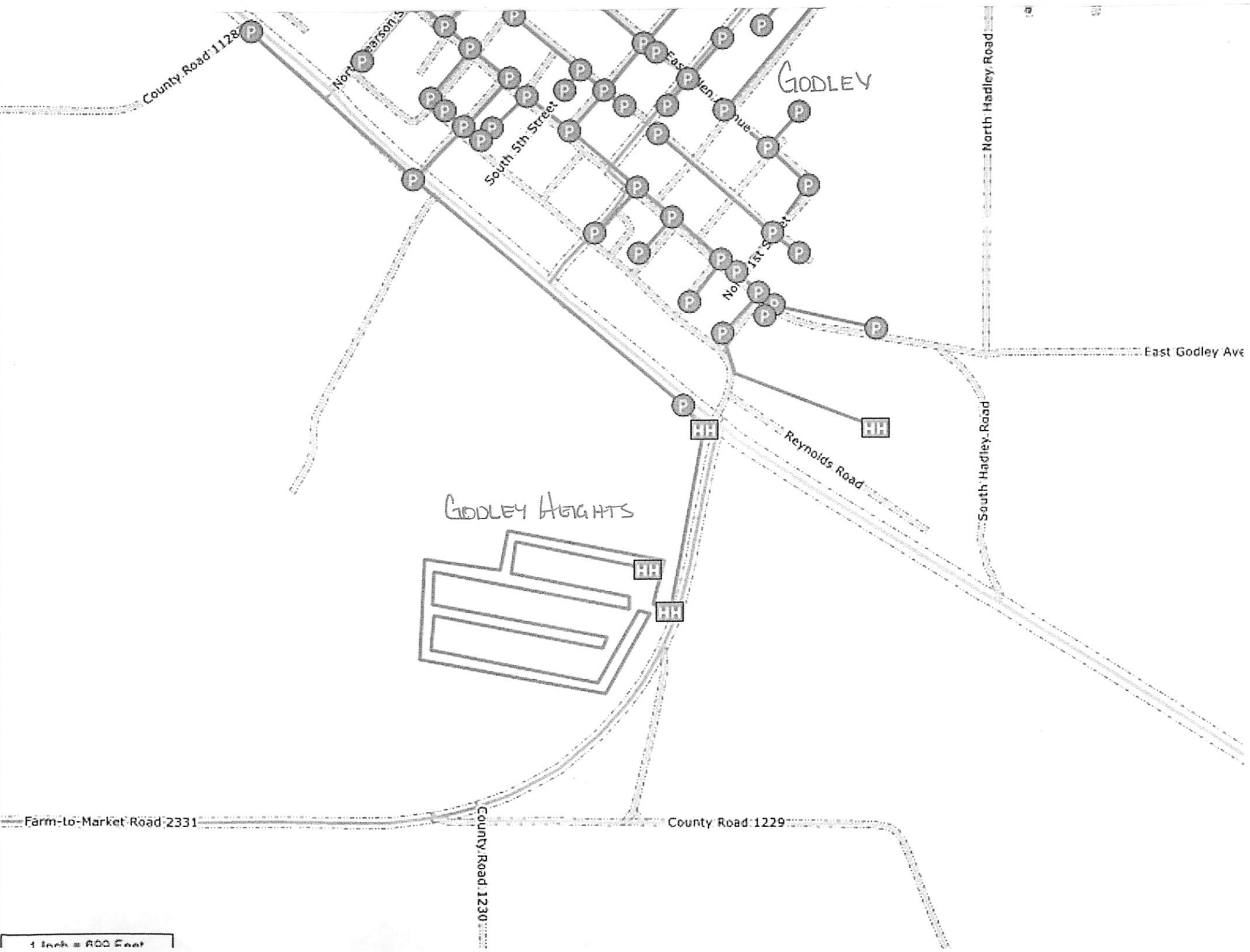

County Road 1128

North Pearson's

South 5th Street

East Glen Avenue

North 1st Street

Reynolds Road

North Hadley Road

South Hadley Road

East Godley Ave

GODLEY HEIGHTS

GODLEY

Farm-to-Market Road 2331

County Road 1230

County Road 1229

1 inch = 600 Feet

JOSHUA

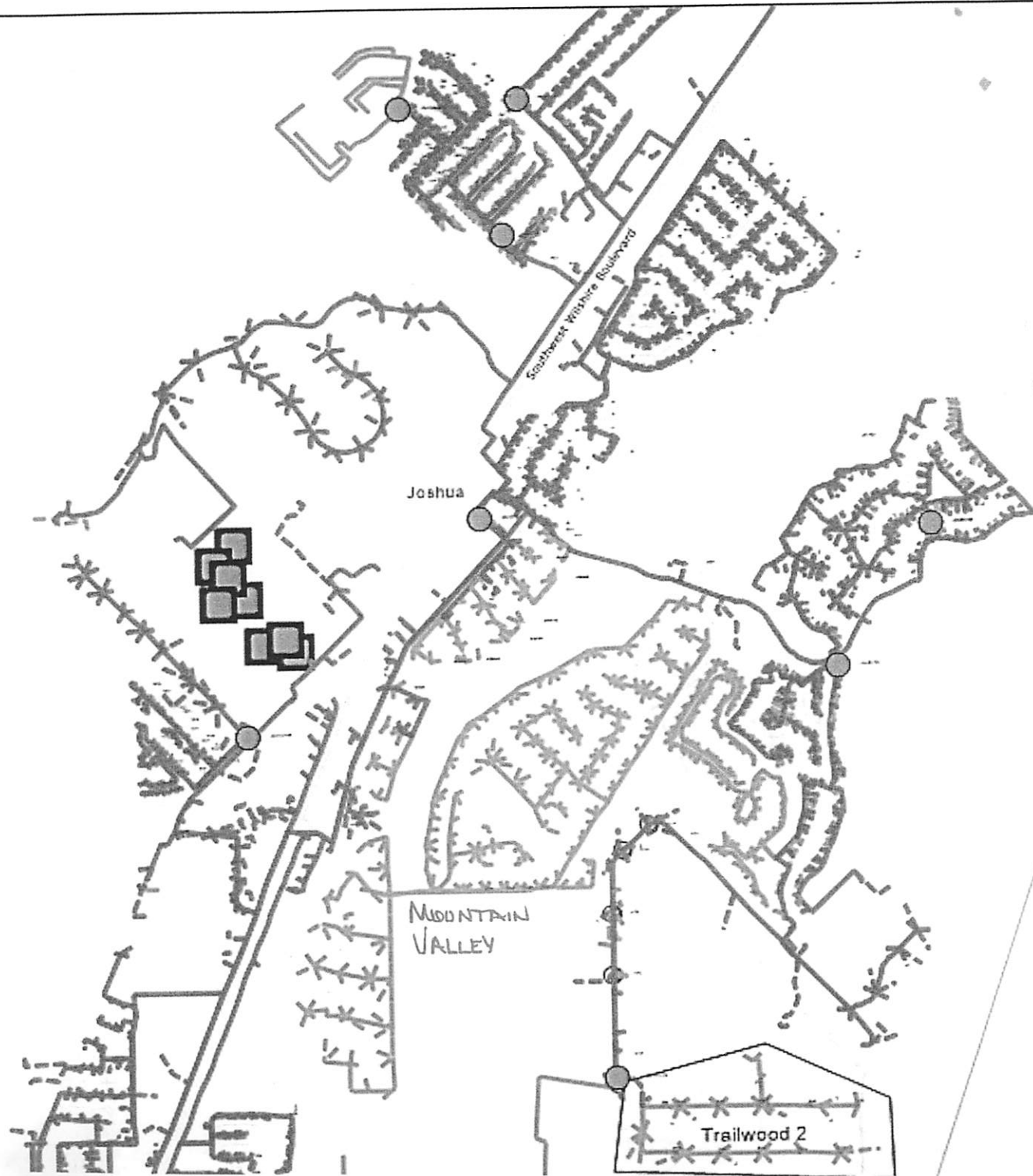

WINDMILL

San-Jo-Market Road 917

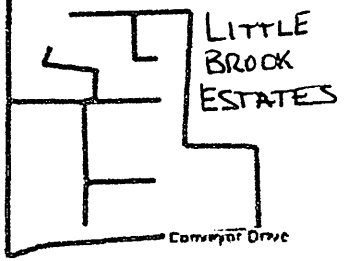
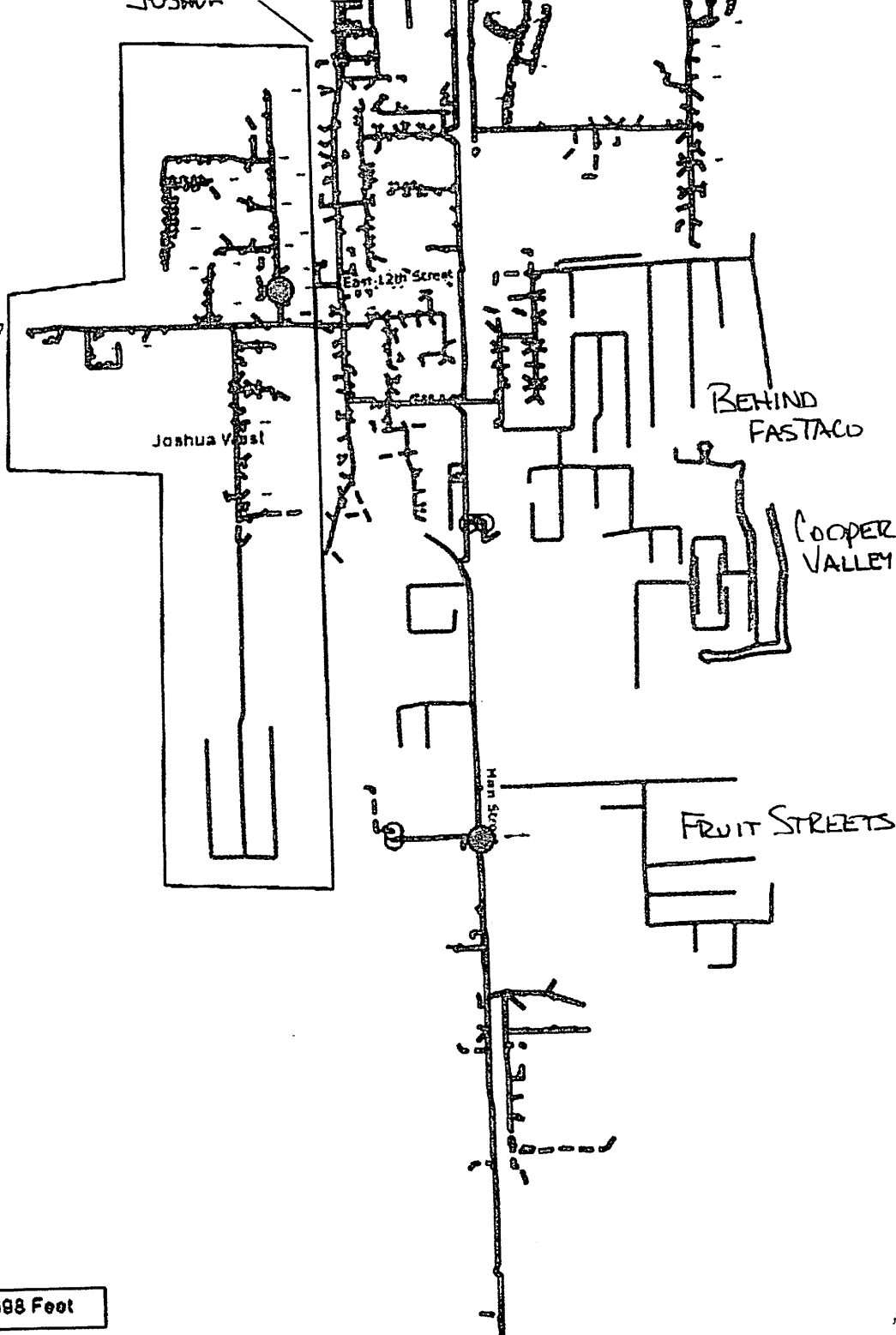

1 Inch = 1,488 Feet